

Alamo Architects



Texas Society of Architects
2014 Honor Awards
Architecture Firm Award

Firm History



Alamo Architects is a multidisciplinary firm of architects, interior design and planners. While proud of our traditional generalist background, we have developed and applied expertise in institutional, educational, retail and multifamily architecture as well as urban design

and planning. Our populist view of the world and our enthusiasm for taking on projects like public schools, shopping centers and affordable housing defines our approach to making resonant and memorable places that transcend budget and circumstance. We have applied a unique sensibility to projects regardless of size, combining innovation and pragmatism in the belief that that good design can change the world – one project at a time.

■ The Beginning

We began in 1984 as a cooperative venture among four friends – Irby Hightower, Mike Lanford, Billy Lawrence, and Mike McGlone. But first we were contemporaries, classmates and friends at the University of Texas at Austin School of Architecture at a time of enormous transition. During our time at UT there were 4 deans and a beautifully (at least to the students) chaotic ebb and flow of ideas, directions and opportunities. As classmates we found a common voice that celebrated Robert Venturi

FAIA's, "Complexity and Contradiction" in the expression of history, theory and context and in a messy world. Graduating in 1977 and 1978, we moved to New York where the galvanizing experience of living in the City and working in dynamic, internationally acclaimed offices cemented our relationship as an extended family.

In 1983, we heard the call to return home to Texas. Lanford after time with Johnson Burgee Architects and with Fox & Fowle Associates committed to the dream of creating a practice with the others by joining Hightower, recently at Friday Architects in Philadelphia, in the establishment of Arrow Associates in San Antonio. They were soon joined at Arrow by McGlone who left Hardy Holzman Pfeiffer Associates. In 1984, they were joined in the establishment of Alamo by Lawrence. Intended as a play on the vernacular, the iconic landmark lends its name to the heroic and mythic as well as local businesses of every stripe. For the nascent practice the name was recognizable, first in the yellow pages and established the importance of the practice over any of the individuals.

■ The Early Years

Like many young firms, practicing in the brutal mid and late 1980's included assisting other practices and squeezing creativity and a living out of humble commissions. The firm's first major work would be history making on several fronts. The Fairmount Hotel, a local landmark, was in the way of the largest downtown redevelopment since Hemisfair in 1968. The firm planned and coordinated the move (the largest building moved

on wheels) and relocation of the 1,600 ton masonry building through the streets of downtown and over the Riverwalk. The design and execution of the award winning restoration and addition included mitigation of the first archeological evidence of Santa Anna's artillery battery from the battle for the Alamo. In 1987 the firm was recognized in Progressive Architecture's "Young Architects" issue. Late that year they were selected to design the site and celebratory architecture for the mass, culminating Pope John Paul's visit to the United States. The 350,000 in attendance worshipped in front of heraldic banners based on the local folk tradition of papel picado (punched paper) hung from scaffold towers and cranes. Soon after, the practice began building its core retail expertise with the first of several projects for The Rouse Company, America's premier retail innovator, EZ's Restaurants and Bookstop with the adaptive reuse and restoration of historic movie theaters in San Diego and Houston. The firm began its long history of service and involvement in the community with the formation of the first San Antonio Children's Museum.

■ Growth and Expanding Expertise

Clients brought ground breaking retail projects to the firm, establishing the firm as the go to experts in the region for design that integrated architecture with graphic identity and branding. Projects for Bookstop founder Gary Hoover include TravelFest, a venture into personalized self directed travel, served as a precursor to the internet age. Work for The Rouse Company continued, including a major overhaul and addition to the first project in

1984

Alamo Architects founded

1985

Fairmount Hotel move/renovation/addition



1987

Golden Residence



Progressive Architecture "Young Architects"

Papal Mass Site



1988

Northwest Arkansas Mall

Moved office to new location in King William Historic District



Northwest Arkansas and others in New Orleans, Ft. Worth, Austin and San Antonio. A new “once in a lifetime project” was the recreation of the historic Buckhorn Saloon and Museum in downtown San Antonio. Our work with public institutions grew with the commission for San Antonio’s first downtown parking garage with charge to create a mixed use urban building. Jerry Lammers, AIA, the firm’s first professional employee, was named a Principal in 1999 and extended the firms practice on public schools and higher education facilities. The middle decade of practice was celebrated with the completion of the new Humane Society of San Antonio facility. Our expertise as “retail” architects transformed the concept of warehousing of animals into a vital community asset. The new facility was recognized by Architectural Record and Business Week for the measurable difference it made to the core business operations, the reduction in recidivism of adoptions and dramatic improvements in animal health and welfare. The ground breaking design is the industry standard by which other Humane Society facilities across the country are now judged and was the model for the complete overhaul and recreation of the City of San Antonio’s Animal Control facility and operation.

■ More Than Architecture

The last decade has seen the practice expand in reach, size and depth. Begun in 1999, The Shops at La Cantera, nursed through environmental mitigation, the demise of national retailers and the crisis of 9/11, opened with international accolades in 2007. The center was carefully sited and shaped with the existing topography. New technologies and analyzes and basic urban design principals maximized existing air movement, shading and micro environmental

factors to redefine virtually every facet of the retail experience from car to individual store interior. Regional traditions of color, texture and materials were used to craft a unique oasis in South Texas. The firm was selected as the master planners of the Northwest Vista College campus in 2005, supervising buildings by other architects and authoring the design of 3 individual buildings, 2 major renovations and new infrastructure. The leadership of the firm paralleled growth the firm with the addition of Associate Principals, Salvador Garcia, Jr., AIA, James Bailey, AIA and Ariel Chavela in 2008 and the naming of Associates Victor Castillo, RID. Affordable housing across the state and mixed-use projects became central to firms ability to bridge the economy’s financial collapse in 2008. Projects using ISO shipping containers continued the firm’s tradition of innovation and practice. Nicole Marrone, AIA and Jason Hyatt were named Associates and recognized for their roles in advancing the firm’s commitment to sustainability and project delivery.

The firm celebrated with the community the expansion and opening of the Museum and Mission Reaches of the San Antonio River. Founding principal, Irby Hightower, FAIA is in his 16th year as co-chair the River Oversight Committee, has provided the crucial leadership in the transformation and 13 mile extension of the San Antonio River: restoring its ecosystem, creating public space and shaping urban development in the city’s core for decades to come. His work is on a visionary par with those that 90 years ago “saved” the river from becoming a paved storm sewer. This “new” infrastructure of design, urbanity and ecology will transform the city for generations to come.

■ The Future

Recently the firm has been integral to the leadership of the community in establishing urban design as the driving force for the redevelopment of San Antonio. With some of the nation’s preeminent planning firms we have recently authored master plans and design guidelines for the core of downtown and the five mile stretch of the historic Broadway commercial corridor. These have included the River North and MidTown Brackenridge Master Plans, the Northwest Quadrant Downtown Plan and the Downtown Strategic Framework Plan. Our understanding and experience with urban design and retail lent critical expertise to the planning efforts as a member of the HR&A Advisors /Cooper Robertson & Partners 2013 HUD Rebuild By Design finalist project Enhancing Commercial Vibrancy and Resiliency in the Sandy-Affected Region. And the firm looks forward to two transformative projects recently awarded. The design with Gustafson Guthrie Nichol Landscape Architects of the 18 acre Hemisfair Civic Park in heart of downtown and with Munoz Architects for the San Pedro Creek revitalization project restoring the urban creek that runs along the western edge of downtown.

1989

became leading architectural designer for The Rouse Company

1990

EZ’s Restaurants



1995

San Antonio Children’s Museum

1997

Principals join AIA

NW Arkansas Mall

1999

Buckhorn Museum commemorated by cattle drive on Houston St.



Jerry Lammers named Principal



Professional Contributions

PRINCIPALS and ASSOCIATE PRINCIPALS

• Membership and Leadership

- AIA National
 - CM@ Risk Joint Committee
- AIA San Antonio
 - President 2013
 - Board Member
 - Executive Committee Secretary
- Texas Society of Architects
 - Chapter Director, AIA San Antonio
 - Urban Design Committee 2014
- Congress for the New Urbanism
- Council of Educational Facility Planners International
 - Board Member
 - Sponsorship Director
- US Green Building Council

• JURY Participation

- AIA Tennessee - Design Awards 2010
- AIA Alabama 2013
- AIA Missouri

• Speaking / Lectures / Presentations

- AIA National Convention June 2014 "Zona Cultural"
- TxA Nov. 2013 "Forward into History - San Antonio River"
- TxA Nov. 2013 "Our Building Reviewed"
- February 2011: CEFPI San Antonio Chapter: "LEED for Schools from an Owner's, Architects and Contractor's Perspective"
- October 2009: Texas State Architects' Convention: "Texas Rainwater Collection; Big and Small"
- April 2009: Dallas Architectural Forum
- February 2009: US Air Force LEED Conference,

- "So Flo and Martin Elementary Case Studies"
- May 2008: AIA National Convention, "LEED Tour of 3 San Antonio Projects"
- April 2008: San Antonio Go Green Conference - "Recycling a Building"
- PechaKucha #6 San Antonio May 2012
- April 2007: Texas State Librarians Association, "The Future of Library Design"

• Conferences

- AIA National Convention 2007 Tour Guide

• Teaching/Academic Involvement

- Drexel University, Design Instructor
- UTSA, Instructor, Guest Lecturer
- UT Austin, Visiting Lecturer

• Awards

- 2013 "Downtown of the Year" - Centro San Antonio
- 2012 Texas Society of Architects Honors Award; James D. Pfluger Community Service Award
- 2010 San Antonio Conservation Society: Residence 502 Corona
- 2006 Robert H. H. Hugman Award
- Heroes in Preservation Award from the San Antonio Conservation Society
- Bexar Land Trust Award for Leadership in Civic Involvement

• Publications

- San Antonio Business Journal ; Sept. 10, 2007: "10 Steps to a Green Office and an Eco Friendly Staff"
- San Antonio Business Journal ; Feb. 24, 2004: "Architectural Design Can Be a Useful Tool to Help the Bottom Line"



Irby Hightower, FAIA | Michael Lanford, AIA | Billy Lawrence, AIA
 Mike McGlone, AIA | Jerry Lammers, AIA
 Ariel Chavela | Salvador Garcia, Jr., AIA | James Bailey, AIA

• Video Appearances

- July 18 2013: New York Rising Recovery Conference - "Building Back Better"
- April 2013: San Antonio River Authority film - "Sustaining and Enriching Life in South Texas: The Story of the San Antonio River"

2000

Biga on the Banks Restaurant

2002

award winning Projects: St. Mary's Street Parking Garage



Humane Society



2004

Alamo celebrates 20 years



2006

Lead architect for Northwest Vista College Master Plan & CIP



Alamo wins First Place in AIA Softball League

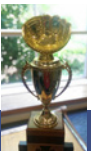

Professional Contributions

STAFF

• Membership and Leadership

- AIA National
 - CM@ Risk Joint Committee
- AIA San Antonio
 - Board of Directors
 - Design Awards Committee Co-Chair
 - COTE Co-Chair
 - Board Member
 - Executive Committee Secretary
 - Chair of Volunteers Subcommittee- Emerging Professionals
 - 2PLP, Co-Chair
 - Building Enclosure Council
 - Skeet Shoot Fundraiser Committee
- Social Economic Environmental Design (SEED)
- imagineSanAntonio, Founder and President
- Texas Board of Architectural Examiners
 - Former Chairman, Board Member
- National Council of Architectural Registration Boards
- HemisFair Park Area redevelopment (HPAC)
 - Citizens Advisory Committee Member
- Society of American Military Engineers (SAME)
- Texas Society of Architects
 - Mentorship Program
- Congress for the New Urbanism
- Council of Educational Facility Planners International
 - Board Member
 - Sponsorship Director
- US Green Building Council
 - LEED Workshop Coordinator
- East Side Initiative 2012

• JURY Participation

- SABJ Going Green Awards Advisory Committee
- UTSA College of Architecture - Guest Juror

- San Antonio College - Guest Juror
- University of New Mexico - Guest Juror
- Drexel University - Guest Juror

• Speaking / Lectures / Presentations / Exhibitions

- TxA 2013 Convention Speaker
- AIA National Conventions "How to Pass the Architectural Registration exam"
- UTSA School of Architecture Guest Lecture
- PechaKucha #5, San Antonio Feb. 2012
- Palo Alto College "Futurescape: An Architectural Adventure"
- AIA-SA 2PLP Course Speaker
- Joven Summer Immersion Program - Guest Speaker
- University of Miami, School of Architecture Downtown Miami - first four years of ideas, group exhibit
- Miami Art Basel Downtown 08 Waterworks, group exhibit
- Scottsdale Museum of Contemporary Art Flip-a-Strip finalist group installation
- AIA National Convention, Chicago, IL 'Home On The Range' winners, group exhibit
- Modern Dutch Housing Conference, Amsterdam 'Home on the Range' winners group exhibit

• Conferences

- AIA National Convention 2007
 - Tour Guide
- Student AIA 2009
- ULI Community Action Grant-Infill Development
- Agents of Change 2004
- New Mexico Heritage Preservation Alliance
 - Presenter

• Teaching/Academic Involvement

- UTSA College of Architecture - Adjunct Professor, Panelist, Instructor, Studio Reviewer
- San Antonio College - Instructor

- University of New Mexico - Instructor
- University of Incarnate Word - Asst. Professor
- Southern Illinois University - Staff Assistant
- Kansas State University - Instructor
- Andhra University, India - Instructor
- Delaware Technical & Community College - Adjunct Faculty
- University of Delaware, US Dept of Energy - Solar Decathlon - Consultant / Mentor
- University of Delaware, Department of Mechanical Engineering - Guest Lecturer

• Awards

- SABJ "Women of Influence" 2009
- Preservation Texas - Merit Award 2014
- Rice University Margaret Everson-Fossi Fellowship
- AIA National COD
- AIA Western Mountain Region
- AIA Arizona
- AIA Delaware
- AIA San Antonio
- Downtown '08 Waterworks
- SMOCA Flip-A-Strip

• Publications

- Texas Architect
- Editor, "ARE Site Design Study Guide, 2007"
- San Antonio Business Journal
- San Antonio Express-News
- Biscayne Times
- Architectural Record On-Line
- Competitions Magazine
- Architect Magazine
- LandArch Competition Annual
- Architectural Products
- Miami Herald

2007

International ICSC Design Award
for The Shops at La Cantera



Move to new award
winning office in SoFlo area



National AIA
Convention Tour Guides



2008

New Associate Principals
& Associate named



Mission Academy University United
Methodist Church

Contributions *to the* Community

- **Mentorship**

- UT School of Architecture
 - Peer Mentor
- Green Schools Mentorship
- Prototype Design Camp
 - “Mentoring Young Creatives”
- After School Tutoring
- ACE (Architecture, Construction and Engineering) Mentorship
- Martin Elementary Green School Club - School Mentor
- Architecture in Schools

- **Volunteer**

- San Antonio River Oversight Committee
 - Co Chair 1999-present
- Mission Trails Oversight Committee
 - Board Member 1995-1999
- King William Neighborhood Association
- Beacon Hill Neighborhood Association
- River Improvement Overlay (RIO) District Amendment Task Force, San Antonio
- San Antonio Metropolitan Ministries Homeless Shelter
- Hands Together Ministry
 - Rio Bravo, Mexico
- Southtown Mainstreet Alliance
 - Board of Directors
- Northside Education Foundation
 - Board of Directors
 - Gala Chairman
- Northside ISD Construction Careers Academy
 - Professional Advisory Council Member

- USGBC –Green Schools Challenge
 - Volunteer, Martin Elementary
- Alamo Heights/Fort Sam Houston Soccer Association –
 - Volunteer Coach , Board Member
- AIA National Convention, San Antonio LEED Buildings Tour Leader
- AIA SA - Skeet Shoot
- AIA SA CANstruction Design and Build Competition
 - Organizer, Participants
- Solar San Antonio- Energy Smart Schools Task Force
- San Antonio Academy
 - “Lego Enrichment Class”
- Career Day Speaker
 - Martin Elementary
 - Elrod Elementary
 - Murnin Elementary
 - Nimitz Middle School
 - Nichols Elementary
- Laurel Heights UMC
 - Property Committee
- Wildlife Rescue and Rehabilitation Organizer Fundraiser
 - Bat House Design
- S.T.A.R. (Students Together Achieving Revitalization)
- UTSA Historic Preservation Association
- UTSA College of Architecture
 - Galveston Field Participant (TxA award)
 - Japan Field School
- American Cancer Society Relay for Life Event - Co-Chair

- Our Lady of Guadalupe Church Young Adult Ministry
 - Co-Founder
- Summerfield HOA
 - Architectural Review Committee
- “Alamo 20/20” Monthly Continuing Education for employees
- Leigh Street Design Guidelines



2009

Congress for New Urbanism
Award of Excellence - River North Master Plan

2012

Irby Hightower awarded
TxA Community Service Award in Honor of James D. Pfluger



2013

New Associates named



2014

Designers for Hemisfair Civic Park for San Antonio

30 year Anniversary



Awards | Achievements

International

Int'l Council of Shopping Centers

- 2007 ICSC Innovative Design
Shops at La Cantera

National

Congress for New Urbanism

- 2009 Award of Excellence
River North Master Plan

National Housing & Rehabilitation Assoc.

- 2008 Excellence in Historic Rehabilitation
SoFlo Office Campus

Multi-Family Executive & Developer Magazine

- 2008 Project of the Year
San Juan Square Multi-Family

Retail Traffic Magazine

- 2006 Grand SADI & Superior Achievement
The Shops at La Cantera

Architectural Record/Business Week

- 2004 Award for Design Solutions
Humane Society/SPCA of San Antonio

Chain Store Executive Magazine

- 1994 Retail Store of the Year
Travelfest No. 1, Austin

State

Texas Society of Architects

- 2013 Citation: Unbuilt Category
Law Enforcement Training Center
- 2012 Studio Award
Itinerant Oil Work Housing

UT System

- 2013 HUB Participation-UTSA Parking Garage

Texas Assoc. of School Boards

- 2004 Design/Innovation Award
Phillis Wheatley Middle School

Texas Historical Commission

- 1987 Preservation of Historic Architecture - Design
Fairmount Hotel

Local

AIA SA

- 2013 Citation - Unbuilt Category
Law Enforcement Training Center
- 2007 Mayor's Choice Award
Maury Maverick Branch Library / FS No. 49
- 2007 Commendation for Sustainability
SoFlo Office Campus
- 2007 Citation Award
SoFlo Office Campus
- 2004 Mayor's Choice Award
Fire Station No. 48
- 2004 Mayor's Choice Award
St. Mary's Parking Garage
- 2001 Mayor's Choice Award
Alazan Apache Courts/Guadalupe St. Neighb.

San Antonio Business Journal

- 2013 Best in Commercial Real Estate
Landings at Brooks City Base
- 2011 Green Building Awards
Category: Architect
- 2007 Best Interior Design-Commercial
SoFlo Office Campus
- 2006 Best Interior Design-Commercial
El Tropicano Hotel

San Antonio Conservation Society

- 2012 Historic Preservation/Restoration
Jingu House
- 2010 Historic Preservation
SoFlo Office Studio

City of San Antonio

- 2011 Green Building Award Honorable Mention
Jim G. Martin Elementary
- 2009 Green Building Award Commercial Building
SoFlo Office Campus

Downtown Alliance

- 2008 Downtown's BEST New Office Award
SoFlo Office Campus
- 2004 Downtown's BEST Award
St. Mary's Parking Garage

AIA Houston

- 1999 Honor Award
Palo Alto College Academic Computing Center

Contractor

Assoc. of Builder's & Contractors

- 2011 Excellence in Construction
Brownfield Ventures
- 2011 Excellence in Construction
Market Square
- 2003 Excellence in Construction
Humane Society
- 2001 Excellence in Construction
The Strand Retail Center
- 2000 Excellence in Construction
OLLU Student Services Center
- 2000 Excellence in Construction
Biga on the Banks Restaurant
- 1999 Excellence in Construction
OLLU Flores Residence Hall

San Antonio Masonry Contractors

- 2003 Superior Design Award
Humane Society of San Antonio/Bexar County
- 2000 Outstanding Masonry Design
OLLU Flores Residence Hall
- 2000 Excellence in Design Golden Trowel Award
OLLU Flores Residence Hall
- 1999 Excellence in Design Golden Trowel Award
Palo Alto College Academic Computing Center

Publications

- Silicon Hills "Geekdom Gets a Hip Makeover at its New Digs in the Historic Rand Building December 12, 2013
- San Antonio Express-News "SA urban development headed in right direction" October 25, 2013
- San Antonio Express-News "Homecoming for Jingu Family" October 22, 2011
- Texas Architect "Lakefront Learning" January/February 2011
- San Antonio Express-News "Lone Star neighborhood; A humble throwback" November 11, 2010
- San Antonio Business Journal, Commercial Real Estate Journal "Shopping in Style" 4th Quarter, 2009
- San Antonio Business Journal "Women of Influence; Nicki Mellado" March 6, 2009
- San Antonio Express-News "The Shops to Multiply" March 21, 2008
- San Antonio Business Journal "The Shops at La Cantera set to add office to the mix" March 21-27, 2008
- San Antonio Express-News "From warehouse to a home" March 2008
- City Pages "soflo: New Neighborhood in the Heart of Old San Antonio" March 2008
- San Antonio Express-News "Northwest Vista's New Library" November 9, 2007
- San Antonio Express-News "Architectural Gems Applauded" October 25, 2007
- San Antonio Magazine - "Up on Downtown Architecture" May 2007
- San Antonio Express-News - "So Flo, So Reinvented" April 20, 2007
- Texas Architect - "Open-Air Market" November-December 2006
- Retail Traffic Magazine - "Grand Winner/SADI 2006" May 2006
- San Antonio Magazine - "The Shops at La Cantera: A breath of fresh air in retail design" October - November 2005
- San Antonio Express-News - "Building in Style" October 2, 2005
- Wall Street Journal - "Animal Shelters Upgrade Creature Comforts,"
Humane Society/SPCA of San Antonio and Bexar County April 19, 2005
- Texas Architect - "Humane Domain," Humane Society/SPCA of San Antonio and Bexar County March/April 2005
- Texas Architect - "Fancy Footwork" St. Mary's Parking Garage March/April 2002
- Cover Texas Architect - "Restaurant," EZ's Restaurant June/July 1996
- Texas Architect - "Atmospheric Browsing," November 1990
- Identity Magazine - "Read 'Em and Eat," Winter 1990
- Designers West - "Design for Celebrities," January 1988
- Restaurant & Hotel Design - "Moving Experience," January 1988
- Metropolitan Home - "New Voices," February 1988
- San Antonio Magazine - "Office By Design," February 1988
- San Antonio Magazine - "Forty Under Forty," November 1988
- Progressive Architecture - "Remaking Malls," November 1988
- Domain Magazine - "Masters of Geometry," Winter 1988
- San Antonio Monthly - "Alamo Architects: Building a Reputation," September 1987



Firm Projects



Fairmount Hotel

ONE of Alamo Architects' most notable projects became one for the record books when it was listed in the Guinness Book of Records as the "Heaviest Building Ever Moved On Wheels". As architects for the renovation and addition, we transformed the historic structure into a 37-room luxury hotel. An L-shaped addition, set back from the street to resolve scale and street-line challenges, creates an interior courtyard with the South side of the old building.

Reversed brick coloration, patterned brick in place of three-dimensional formations and gable-shaped arches in place of segmental make the new building distinct yet compatible with its elder partner. They coexist in the heart of the La Villita historic district, with a turn-of-the-century German-English school next door. A red base at the addition carries the storefront line around the building and eases the transition within the same cornice height from three stories to four at the addition's south side.



1986
San Antonio

Size 14,000 sf
Cost Relocation \$1.2 million
Renovation/Addition \$2.5 million
Client Joint Venture of Van Steenberg,
Wright Development and BK Johnson

*Texas Historical Commission "Preservation of
Historic Architecture - Design" 1987*



St. Mary's Street Parking Garage

THE SIX level parking garage was constructed along St. Mary's Street between Pecan and Travis streets. The garage contains ground floor retail and commercial space along St. Mary's Street to maintain the traditional street level character. The garage accommodates 700 cars. Architectural compositional elements are used to break down the perceived impact of the mass of the structure. Strong horizontal elements help break down the six levels of the buildings, including the horizontal canopies at the first floor level. Vertical elements establish a bay system as well as a hierarchy along the facade.

Public Art is included in the lobby areas at the ground floor and adjacent to the elevator at each floor level, both north and south. At ground level the public art is an integral part of the lobby floor and composed of over-scaled shoe images made of precast terrazzo and placed inside a larger terrazzo field. Humorous text and the placement of the shoes create a whimsical and approachable art piece that swirls around the lobby and leads to the outside where the shoes wander down the street. The shoe types are easily identifiable as a particular style. Different shoe styles mark the entry to the elevator on each floor to serve as a memory device for patrons. ("I'm on the high heels floor!") The appropriate shoe image is then reused as a part of the signage at the elevator call buttons.

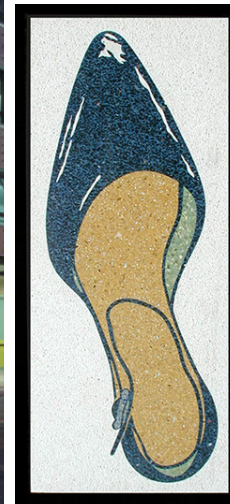

2002
San Antonio

Size 330,000 sf
Cost \$8.3 million
Client City of San Antonio

2004 Downtown Alliance "Downtown's Best"
2004 AIA San Antonio Mayor's Choice Award



Humane Society/SPCA of San Antonio and Bexar County

THE NEW facility for the Humane Society in San Antonio represents a unique and revolutionary approach to the problem of shelter design, transforming the visitor experience from a bleak and depressing ordeal into a lively, fun and exciting interaction with animals available for adoption. Designed to be a focal center for animal care issues and adoption in San Antonio, the planning ideas revolve around a group of buildings surrounding a landscaped park space where visitors can spend time in the open air with potential animal family members. Bleak prison-like building blocks usually associated with a typical shelter have been rejected in this design response, and instead the animal care areas are broken into campus of individual buildings with smaller sunlit spaces surrounded with play yards where the animals can get daily exercise or visit with potential adoptive families. Interior finishes mix durability with playful color, and animals are housed in actual room size enclosures, visible through glass walls. Familiar regional forms and materials are employed to create a friendly setting, with large overhanging roofs and vine-covered trellises providing shelter from the elements. Designed to include spaces for evolving outreach programs like pet care and dog training, the facility includes an educational building and training yard, as well as space for other smaller charitable function this new courtyard-focused complex seeks to become a new center in San Antonio for responsible pet care and adoption.



2002
San Antonio

Size 22,000 sf
Cost \$4 million
Client Humane Society/SPCA of San Antonio
and Bexar County

2003 Excellence In Construction Award- ABC
2003 AIA Merit Award - Outstanding Architectural Design and Achievement
2003 Golden Trowel for Superior Design
2004 Business Week/ Architectural Record Award



The Shops at La Cantera

CREATED as a prototype idea for future development of regional scale outdoor centers by General Growth Properties, the design addresses both modern environmental concerns about land use and nature conservancy and evolving changes in shopping patterns.

Overall planning for the center was developed initially with the goal of preserving as much natural landscape as practical. Site edges were preserved largely as wild landscape, which provides a green-belt buffer to the adjacent freeway. Located in a highly environmentally-aware community, The Shops at La Cantera is particularly sensitive to the conservation of natural resources.

The Shops at La Cantera blends the visual heritage of San Antonio and the Texas Hill Country with the fashion edge necessary to support a setting for high-end retailers, incorporating detailed hand-crafting and artisanal materials alongside crisply detailed steel and cut stone. Phase I opened to public acclaim in September, 2005 and Phase II opened in the Fall of 2008.



2005 / 2008
San Antonio

Size 1.4 million sf
Cost withheld
Client General Growth Properties

2007 ICSC International Design Award –
Innovative Design & Development of a New Project (over 500,000 sf of retail space category)

2006 17th Annual Retail Traffic Magazine
Superior Achievement in Design & Imaging (SADI) Awards for "Best New Open Air Center" and "Grand SADI" Best of Competition.



The Shops at La Cantera





SoFlo Office Studio

AN OLD industrial warehouse on the southern edge of downtown San Antonio was adapted into a spacious and technologically sophisticated work environment. The two independent firms of Alamo Architects and OCO Architects who share the 2-acre office campus took great care to minimize the site's new environmental footprint. The firms used the opportunity to develop what they collectively consider a model for future sustainable projects. Rather than demolishing the dilapidated structures, the owners sought historic designation of the industrial property. The architectural efforts honor the industrial heritage of the structures and area as well as the neighborhood by renovating what was primarily a structural skeleton and adaptively reusing the parts and pieces of the demolition process normally sent to the dump with creativity and a sense of humor.

Zoned for heavy industrial, the property was rezoned using a city incentive program that encourages the redevelopment of "infill" urban sites. As a part of the rezoning process, the architect facilitated public meetings with the city's historic preservation office and planning and zoning departments. To obtain community support for the project, the owners held a series of neighborhood meetings with residents, local business owners, and community groups to discuss the redevelopment and renovation plans and the integration of the project into the existing Neighborhood Master Plan.



The property's original structure was constructed in 1948. All the reclaimed and reused materials were left in their aging, unfinished condition. All of the original concrete paving, as well as some from another nearby site, was reused as "poor man's flagstone." The largest pieces were simply tilted up and secured to recycled posts as the fence along the north and west property line. The height was kept low enough that the immense agaves and succulents growing next door are incorporated visually into the two visitors' courtyards. Even the abandoned concrete fork lift counter weights were reused as benches in the beer garden.

2007
San Antonio

Size 72,000 sf
Cost withheld
Client Alamo Architects/OCO Architects

*Certified LEED Silver by the USGBC
2007 AIA San Antonio - Commendation for Sustainability
2007 AIA San Antonio - Citation Award
San Antonio Business Journal
2007 Best Commercial Real Estate -
"Best Interior Design"
"Eco-Friendly Office Space"*



Northwest Vista College Master Plan & Capital Improvements Projects

ORIGINALLY built in 1997 for 3,300 students, Northwest Vista College has today grown to support an enrollment of more than 16,000. In implementing the Master Plan for this rapidly-growing campus, Alamo Architects brought design experience with community colleges, a historical perspective of this particular campus, and continuity of the planning process that was required to bring the new Campus Master Plan to life. Alamo Architects' Master Plan demonstrates creativity and practical solutions. The primary goal was to make the campus a place of learning and enlightenment, as well as a distinctive community landmark. The new campus design establishes clear concepts for circulation and parking at the Northwest Vista College Campus.

Among the guiding principles established, several elements were prioritized: Preservation and celebration of the native landscape, development of a more natural connection between the buildings and the landscape and creation of a campus with the characteristics of a university and the convenience of a community college.

Alamo was subsequently selected to be the lead architectural firm for the implementation of the College's 450,000 square foot expansion program.



2009
San Antonio

Size 135 acres / 437,000 sf
Cost \$13.5 million
Client Alamo Colleges

*2011 ASLA Texas Chapter Merit Award:
Public Design Constructed*



Japanese Tea Garden | Jingu House

THE Japanese Tea Garden holds historical significance within the City of San Antonio. From a humble beginning as a quarry for concrete manufacturing to its construction using prison laborers, the gardens blossomed not only into a beautiful park space but later a home for the family of the caretaker, Kimi Eizo Jingu.

Having fallen into decline and disrepair, The San Antonio Parks Foundation enlisted Alamo Architects to re-envision the former beauty of the of Jingu House while planning for current and future needs. Alamo Architects produced a series of atmospheric sketches and plans specifically drawn for the capital campaign. These drawings were intended to convey the possibilities before the designs were fully developed and to help attract donors to the project. Alamo Architects next was retained to provide full architectural services for the renovation of the Jingu House and Mexican Village buildings. Through a combination of on-site inspection and dissection of historical documents, the Team developed designs to restore the original Bamboo Room, a small restaurant that once operated out of the Jingu's home.



2010
San Antonio

Size 33 acres
Cost Pond & Garden, \$1.5 million
Jingu House, \$750,000
Client San Antonio Parks Foundation

2012 San Antonio Conservation Society
Historic Preservation/Restoration



Cevallos Lofts

OVERLOOKING the La Tuna Ice House and the San Antonio River hike/bike trailhead in the post-industrial Southtown Arts District, this pioneering mixed-income multi-family development is the first major concentration of new rental opportunity south of Downtown. Underground parking minimizes site constraints and allows the building to respond appropriately to the redeveloping urban context. Management functions and amenities are pushed up to the street with glazed storefronts to book-end the building while stoop-served live/work units establish an authentic urban residential experience in between. The building's corbelled brick masonry, stucco, and corrugated metal skin reinforce a material connection with neighboring utilitarian structures while embracing a distinctly contemporary aesthetic.



2011
San Antonio

Size 252 units
Client NRP Group

2011 Downtown's BEST Award, "Best Residential Work in Progress," Downtown Alliance San Antonio



Encinal Container Housing

THIS PROJECT sought to provide a quick, low cost, sustainable, multi-family housing option for a better quality of living for oil and gas workers in Encinal and other locations. In South Texas, the drilling for oil and gas in the massive Eagleford Shale formation has created enormously complex demands on the small towns across a region that stretches from Victoria to Laredo as the flood of workers consume every bit of the limited traditional housing stock. Workers across the industry work long hours in harsh conditions and have extremely limited, and consequently very expensive, options for places to live. Many live in cramped trailers, ramshackle camps, pop-up RV parks and "hot bunk" houses where sleeping and living are shared on a shift basis.

Due to the remoteness of the location, options for traditional on-site construction are extremely limited with materials and skilled labor either hours away or exceedingly costly due to competition with drilling operations. 700 Berry Street utilizes re-purposed ISO shipping containers with pre-fabricated components assembled 120 miles north in San Antonio. Manufacturing processes and assembly line production techniques allow for greater quality control, speedier delivery and lower costs.

The containers and components were then trucked to Encinal to be quickly erected and assembled. The containers are utilized for their low cost, strength, ease of transport, durability and sustainable benefits. Other unitized components like roof shading devices, stairs and balconies will also be trucked to the site and assembled as the containers are erected.

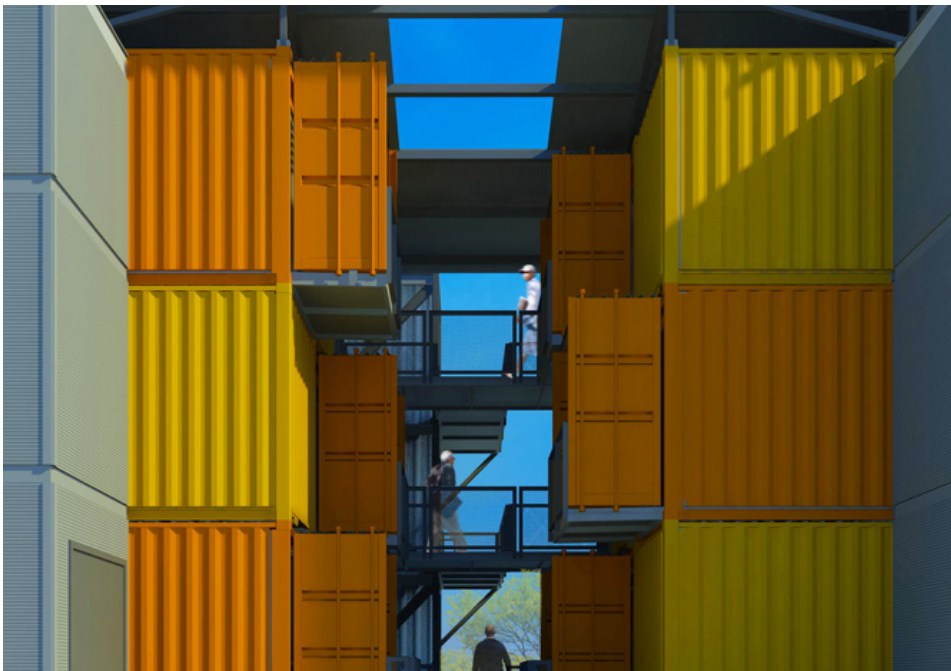

2013
Encinal, Texas

Size 31,960 sf
Cost withheld
Client 2446 Encinal Development, LP

*2012 Texas Architects Studio Awards,
AIA/Texas Society of Architects*



Law Enforcement Training Center at First Responders Academy

ALAMO COLLEGES needs to expand its existing First Responders Academy with new classrooms, administrative space and outdoor training areas for the Law Enforcement Training Center. The new buildings need to be sustainable, durable and exemplify the mission of the Academy.

Over time Alamo Colleges has collected 57 shipping containers for storage at its various campuses. The district sought to find a way to re-purpose their containers to a higher use. Utilizing the shipping containers to serve as armatures which will support elevated classrooms, administrative support spaces and shaded, outdoor spaces will reduce the overall budget for the addition.

The reinforced containers, which support the floors and roofs of the classrooms, will house highly secured armories and other support spaces. Their color and graphic scheme is inspired by police caution tape and provide a dynamic and contemporary expression of the Academy's mission. The new campus addition is arranged around a central courtyard that acts as a protected communal space as well as an outdoor training ground. The courtyard plan is oriented along an east-west axis to better control solar heat gain. Classrooms are well day-lit with abundant south facing glazing that is shaded by large overhangs.

The classrooms are connected by a wrap-around elevated deck which looks out over the courtyard providing various viewing options for training exercises. The courtyard ends on an elevated shipping container shade structure which is supported by ground level, open air, shipping containers that can be used as informal learning spaces.

est. 2014
San Antonio

Size 14,184 sf
Cost est. \$4.5 million
Client Alamo Colleges

*2013 Texas Society of Architects Citation:
Unbuilt Category*



